

线束和搭铁位置

发动机室 (1/7)

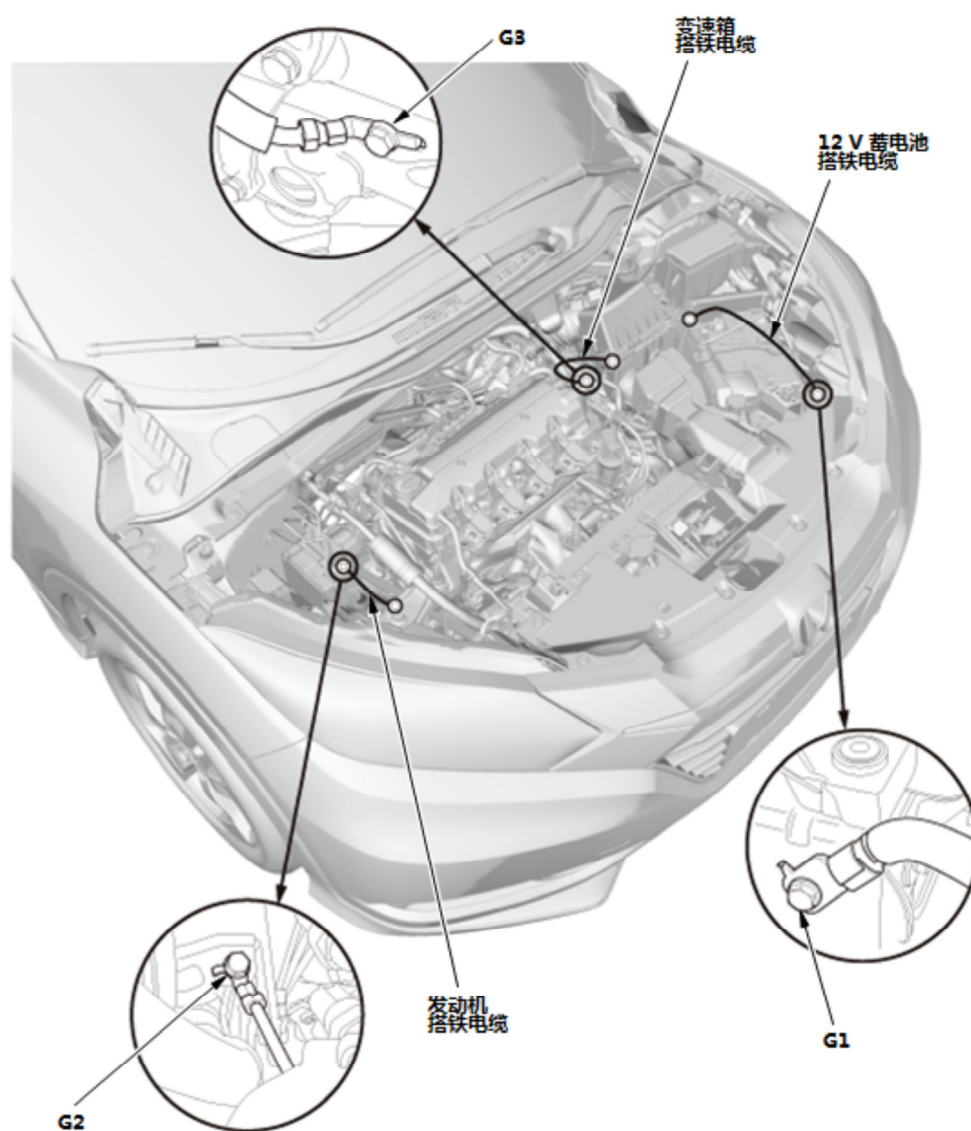

发动机室 (2/7) (CVT, 1.5 L)

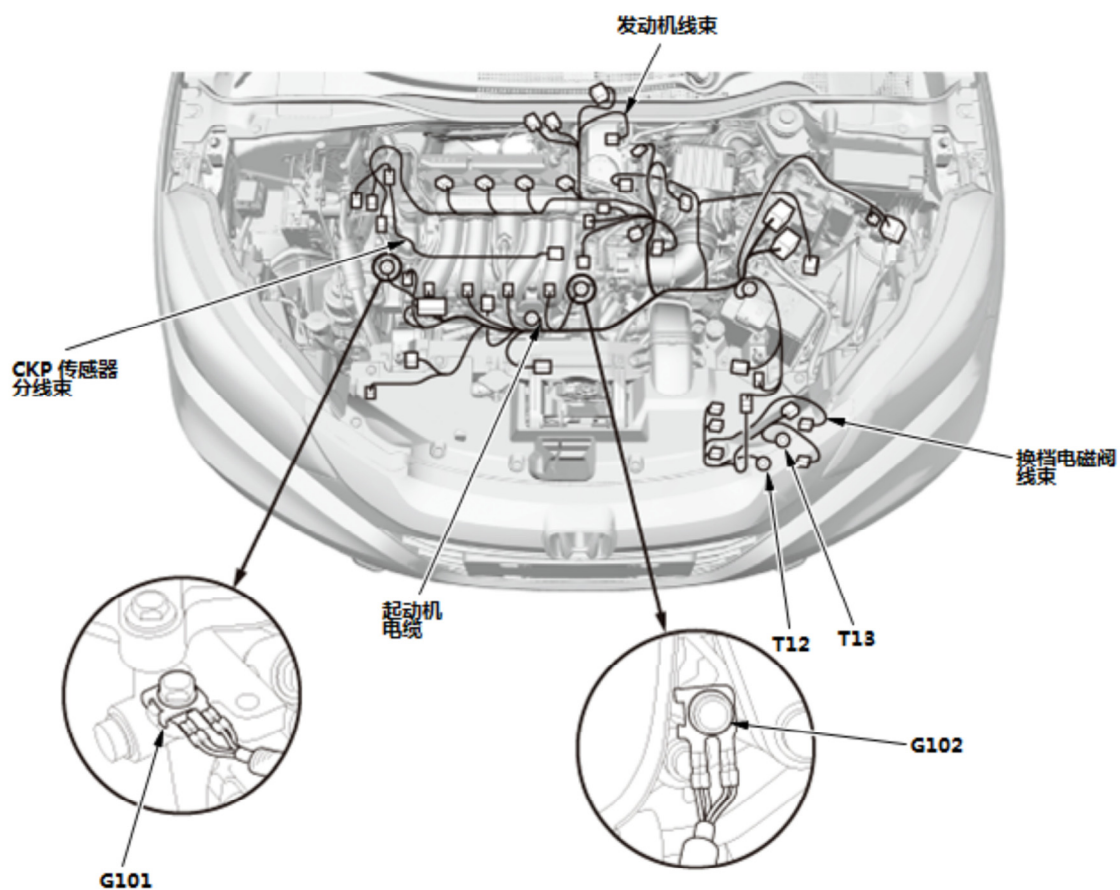

发动机室 (3/7) (CVT, 1.8 L)

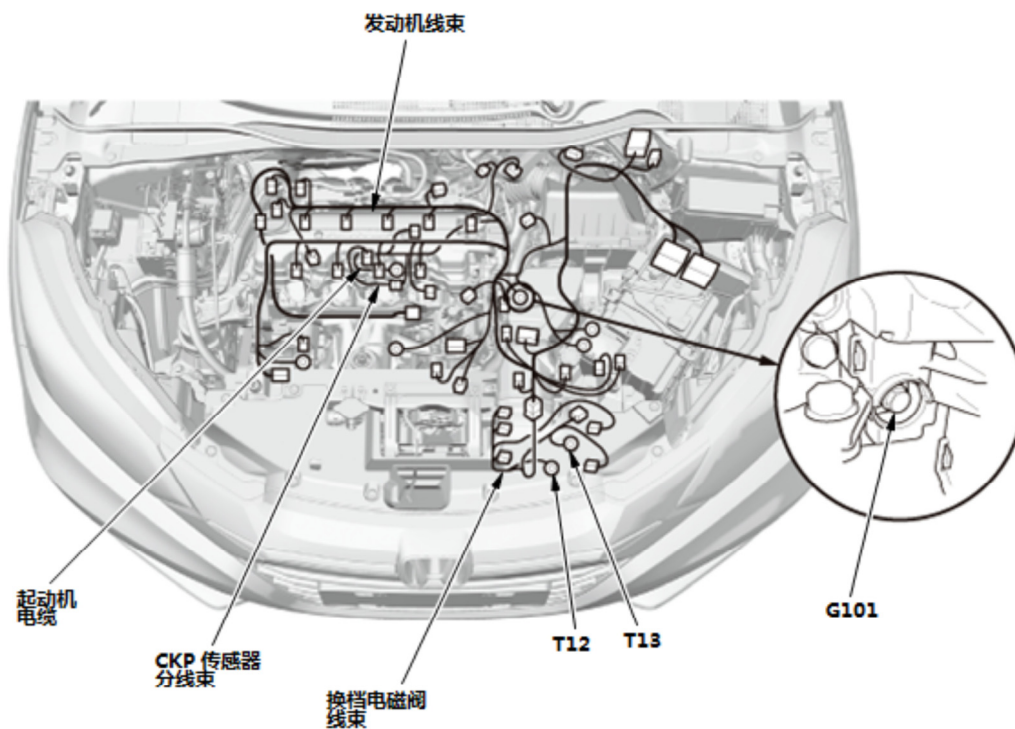

发动机室 (4/7) (M/T, 1.5 L)

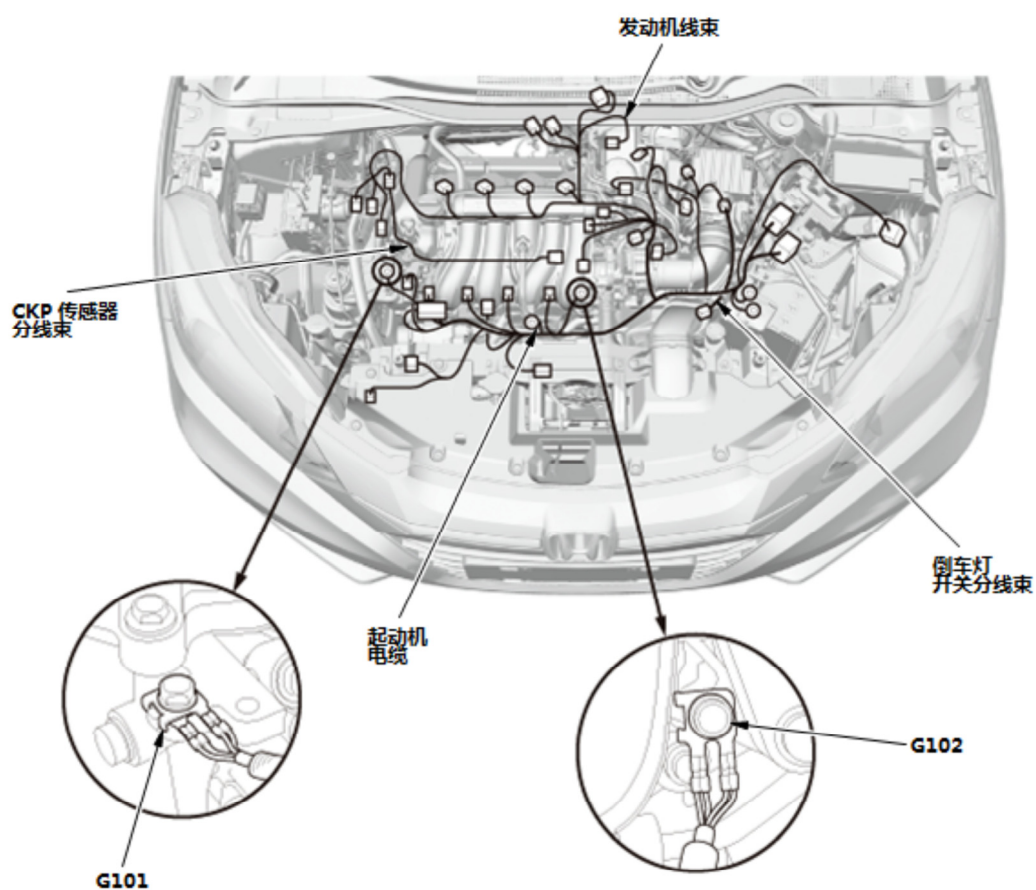

发动机室 (5/7) (M/T, 1.8 L)

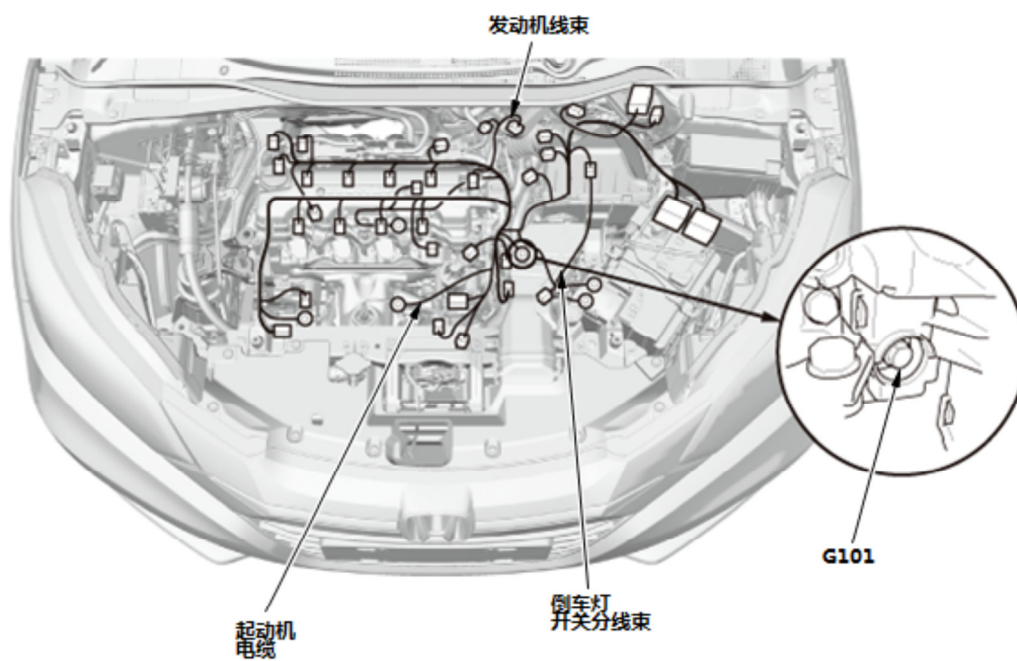

发动机室 (6/7)

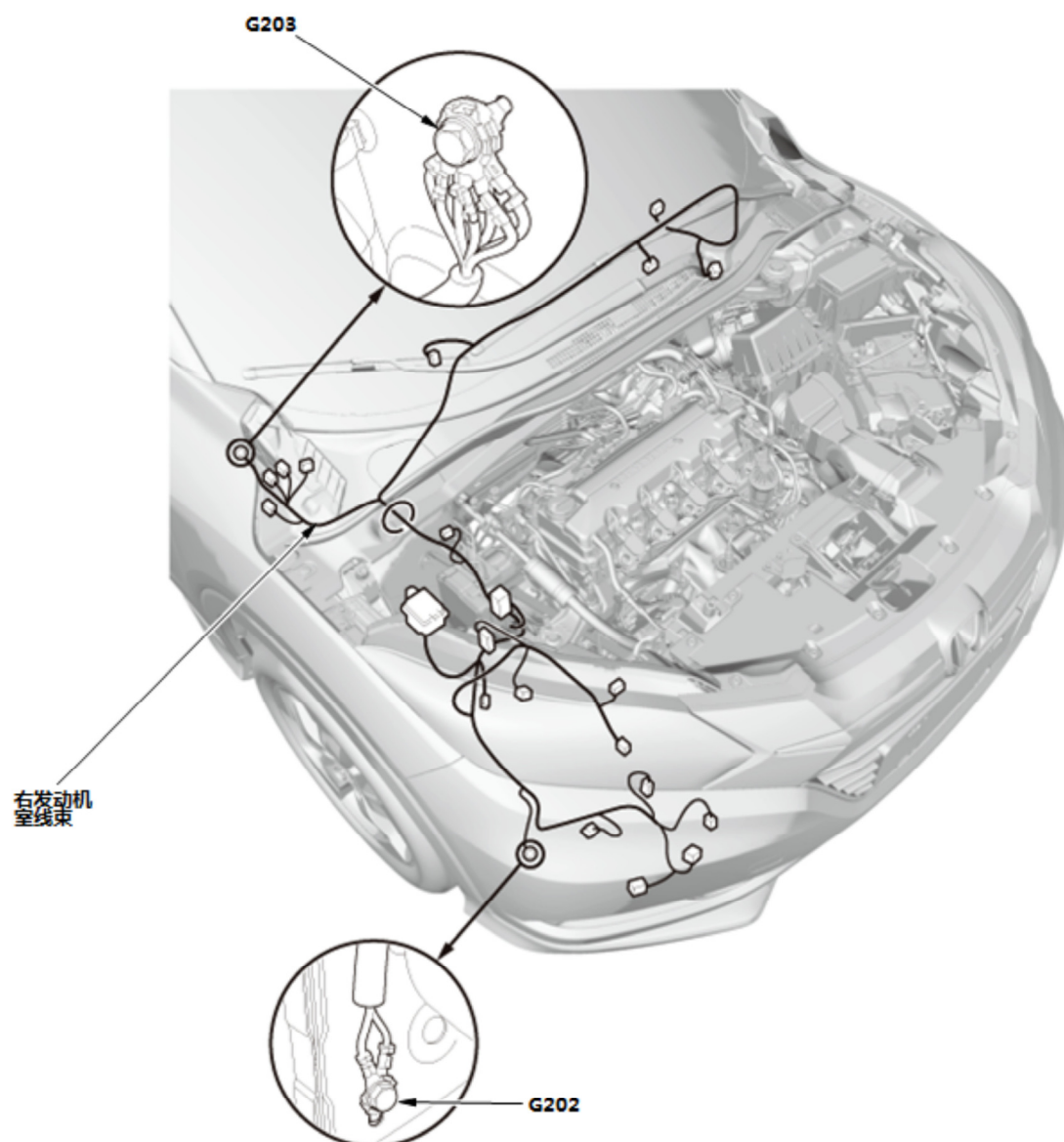

发动机室 (7/7)

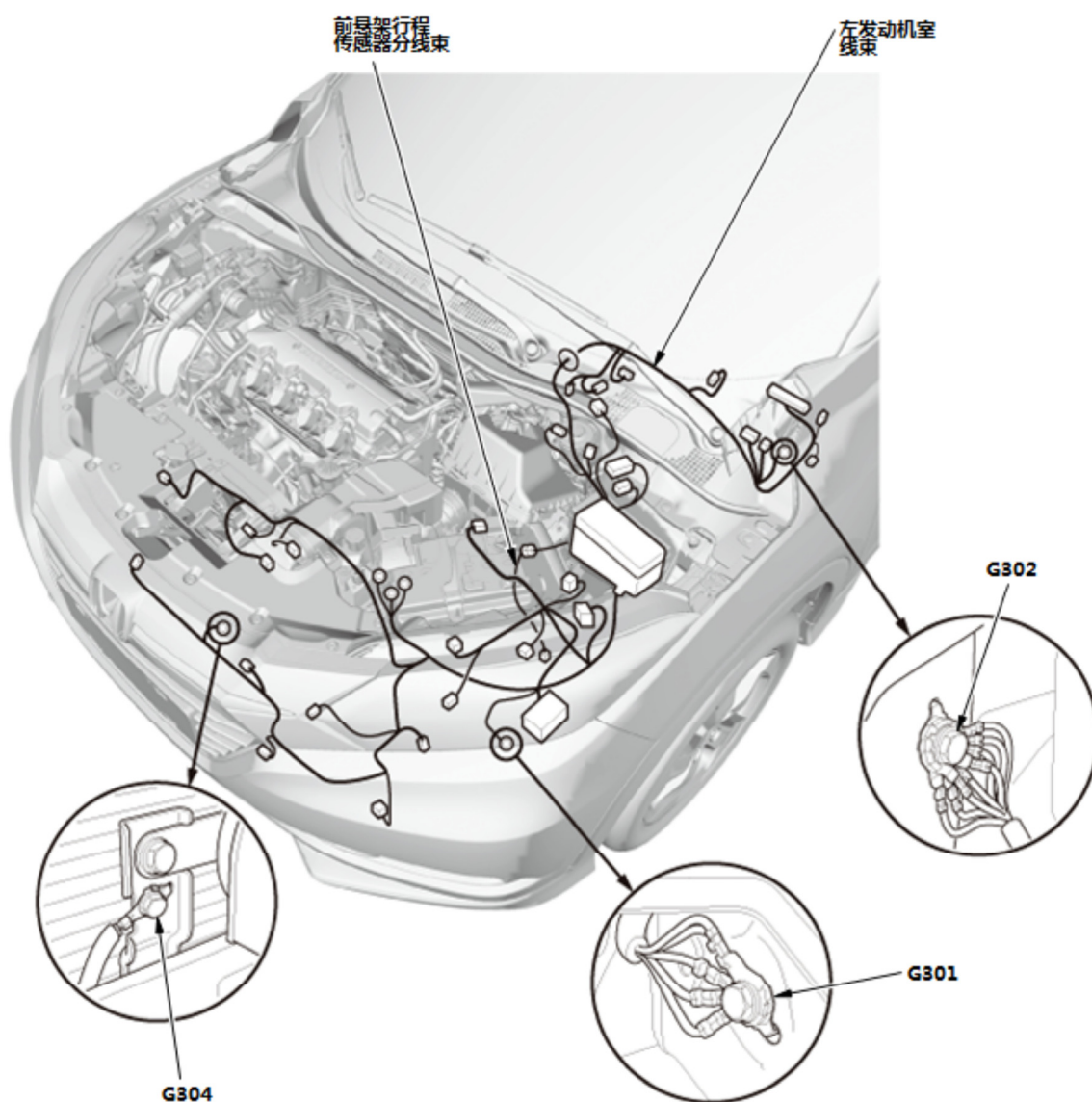

仪表板 (1/2)

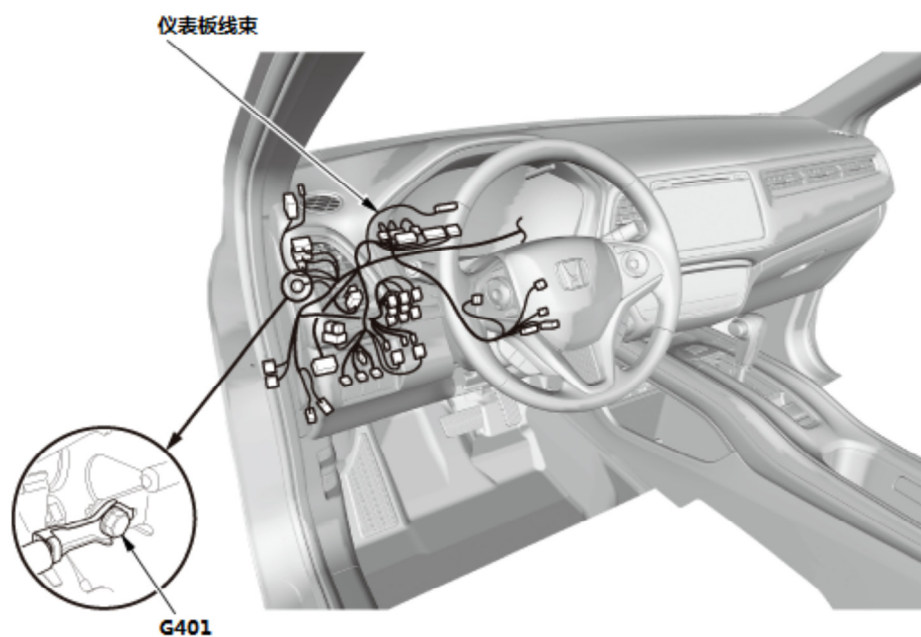

仪表板 (2/2)

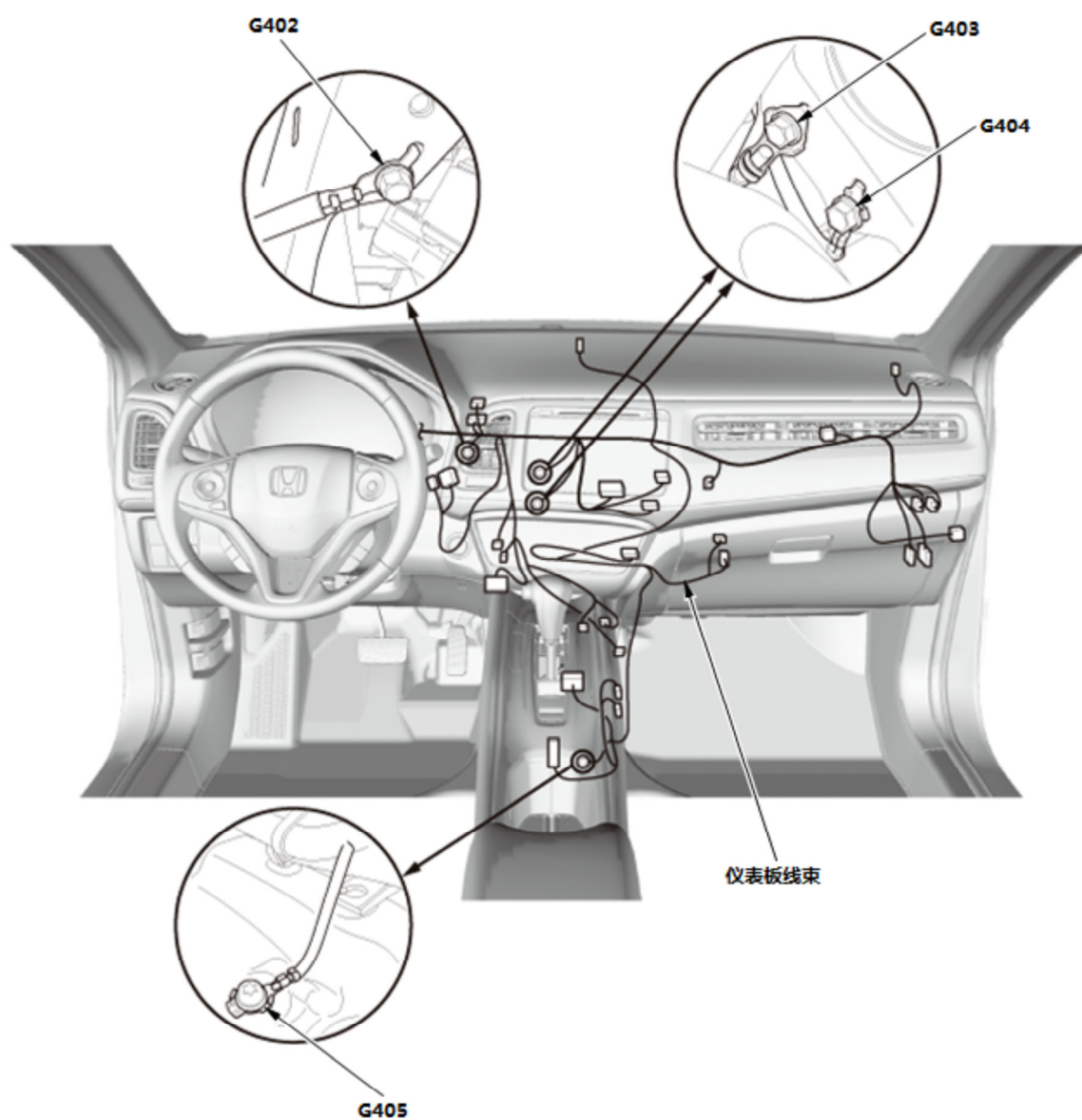

转向系统

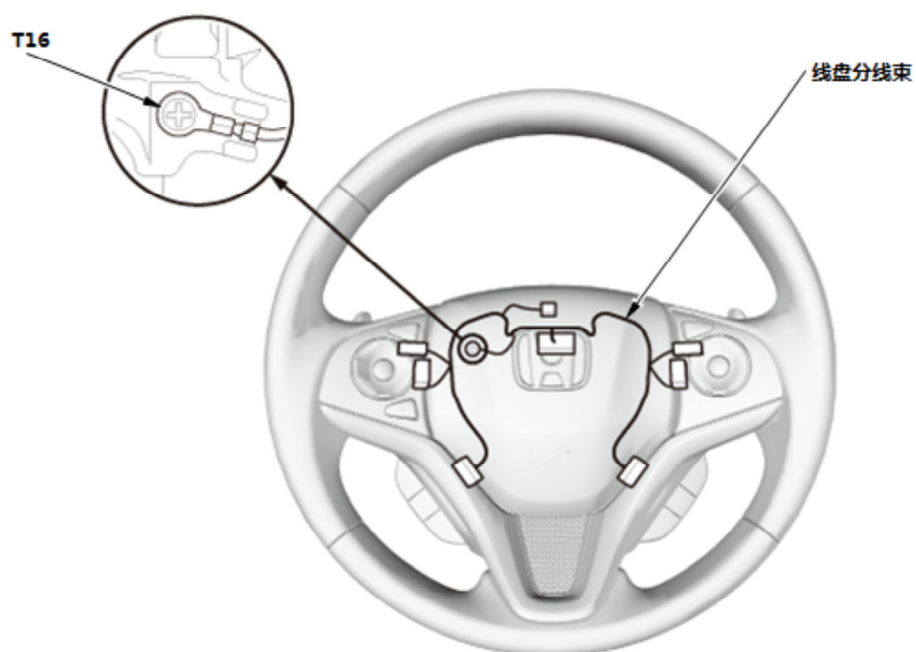

车顶 (1/2) (不带全景玻璃车顶)

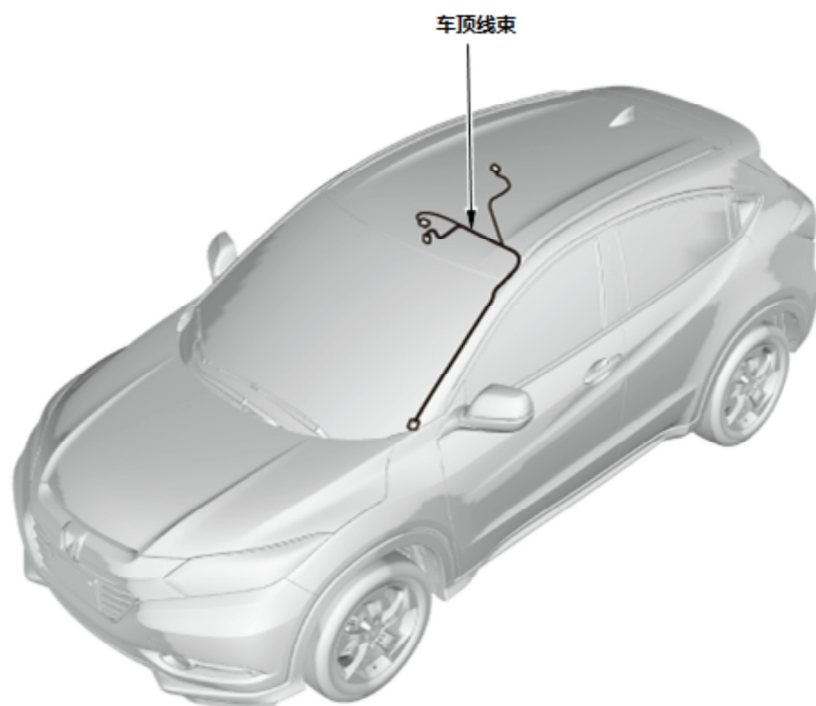

车顶 (2/2) (带全景玻璃车顶)

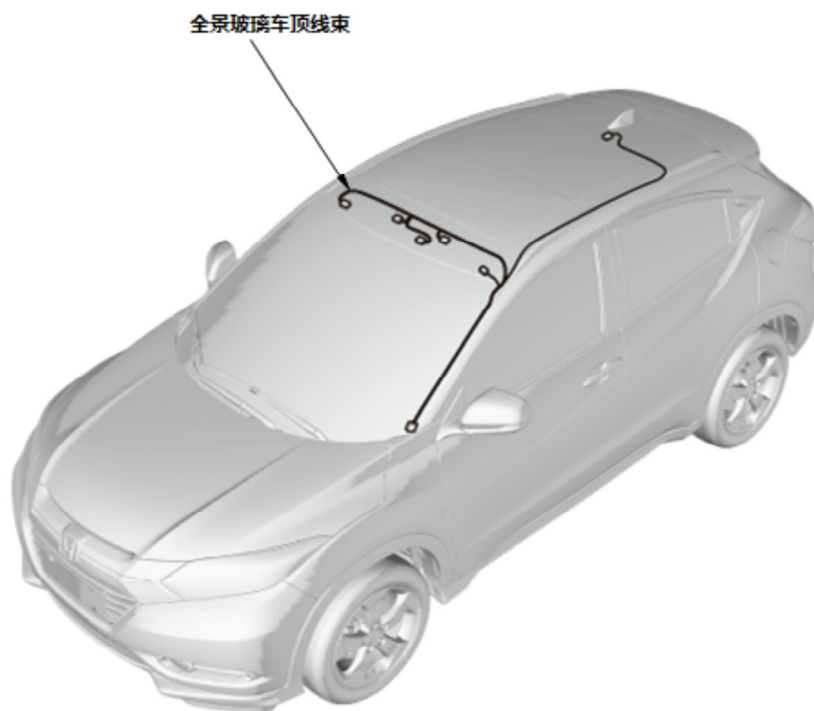

地板 (1/2)

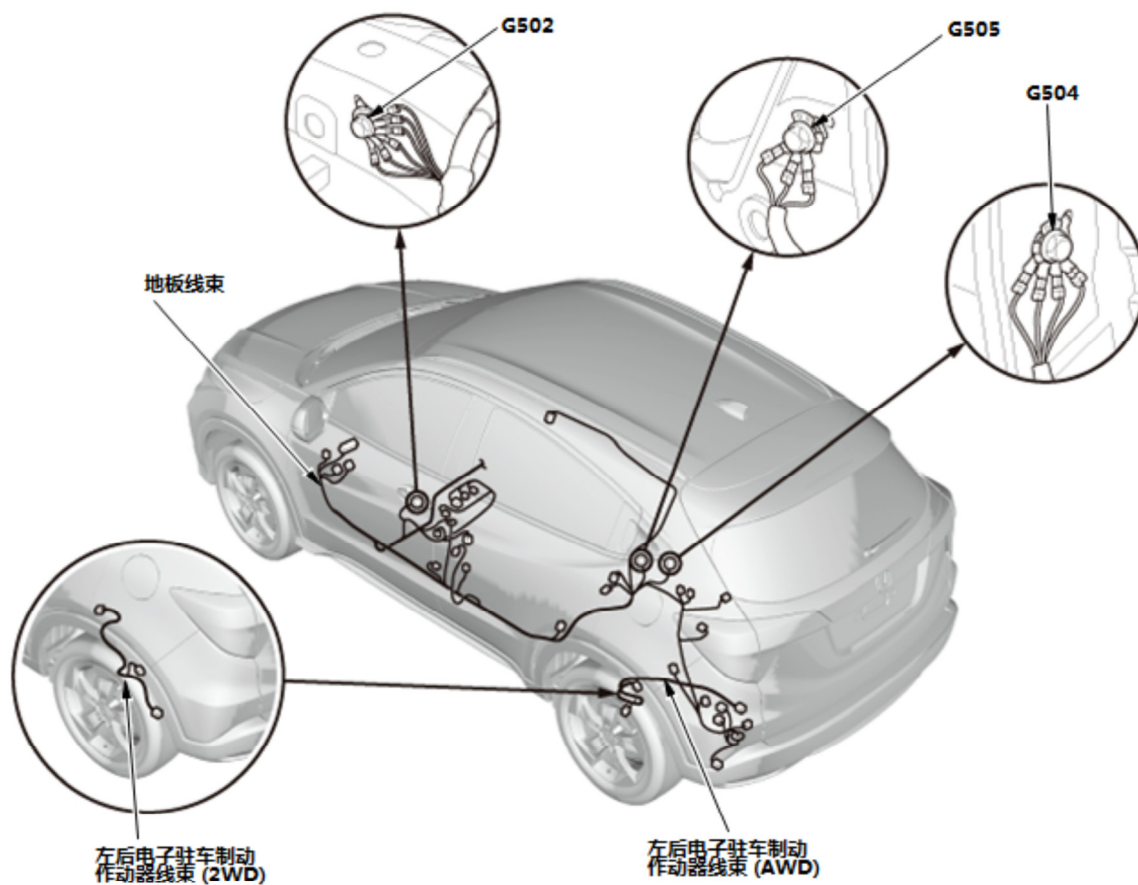

地板 (2/2)

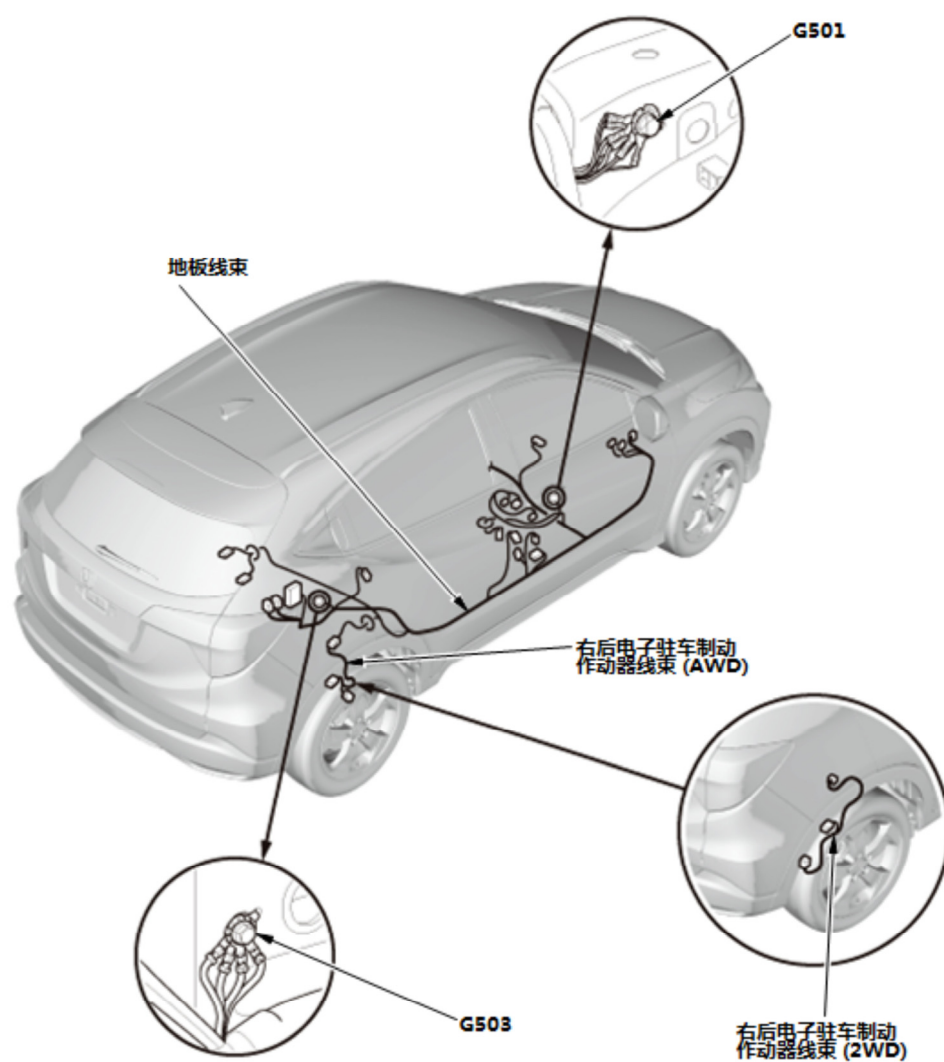

后部和尾门

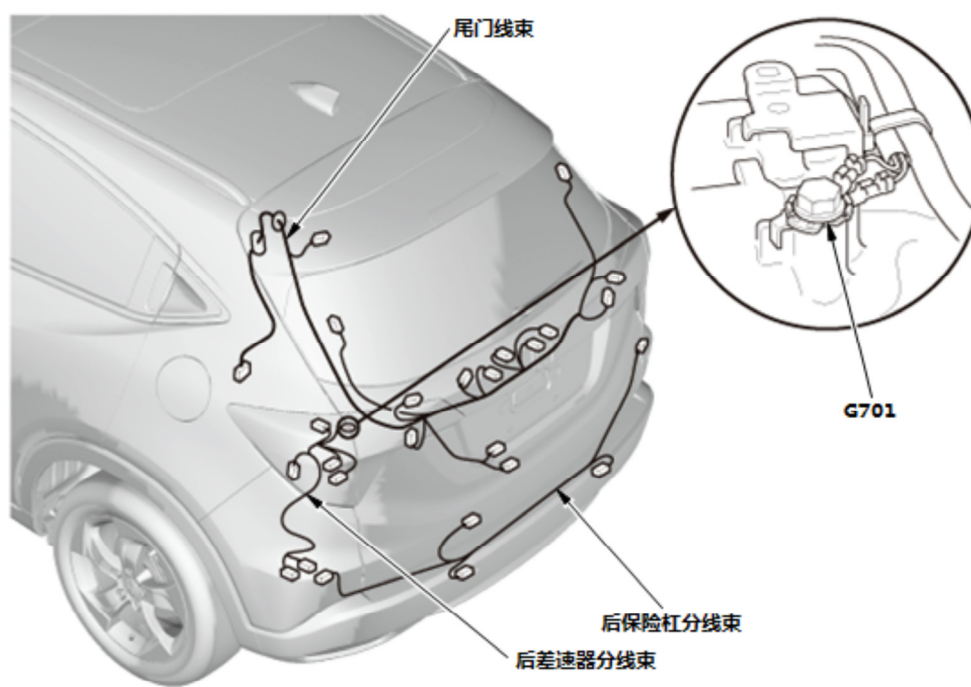

鼓风机

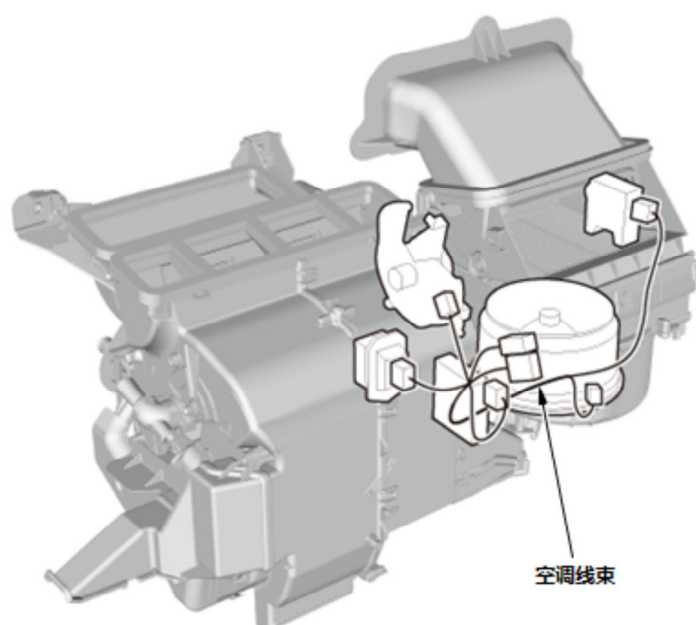

车门 (1/4)

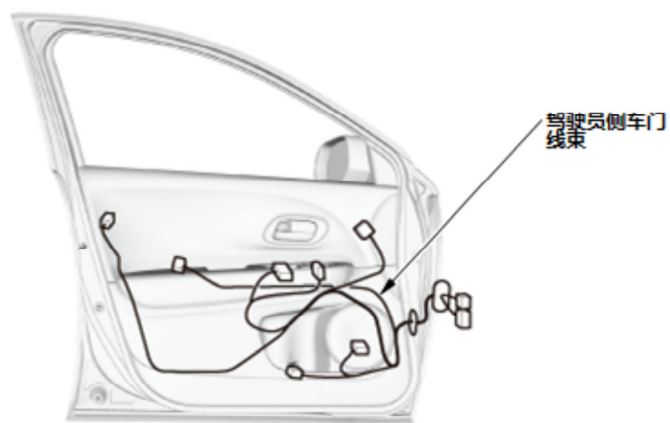

车门 (2/4)



车门 (3/4)



车门 (4/4)

